



TRUST YOUR HOME TO ANDERSEN™

ANDERSEN WINDOW GUIDE

▶ WINDOWS 101

▶ DESIGN INSPIRATION

▶ COMPARISON CHART



LOVE THE LIFE YOU SEE®

Windows are one of the most important elements in your home's design. With the ability to let in energy- and mood-boosting natural light, highlight views, and usher in fresh breezes, their power goes beyond the purely functional. They can make a room and change the way you feel and live in your space.

We're here to guide you through the process of picking out windows that'll make you love the way your home looks, feels, and functions. Let's get started!



CONTENTS

02
3 steps to selecting new windows
Let's narrow down your options

03
Windows 101
Window types and vocabulary

05
Creating a look
Color, grilles and hardware



15
Glass
Types, upgrades, and more

19
Find your window series

COVER
400 Series tilt-wash double-hung and picture windows in black.

GETTING STARTED

3 STEPS TO SELECTING NEW WINDOWS

Narrow down your options by working through the following questions:

- 1 What types of windows do you want?**
Knowing what the types of windows are called and how they work is the first step to understanding your options and essential to successfully working with a pro.
- 2 What look are you going for?**
Details like size, color, grilles, and hardware collectively create a look. Learn to navigate all these options to create a look that suits your home's style.
- 3 What are your needs for energy efficiency?**
Understanding glass is key to selecting optimal windows for your climate and geographic location.



THIS PAGE, LEFT TO RIGHT
100 Series casement window in black, 400 Series casement window in dark bronze, 200 Series tilt-wash double-hung window in white with window opening control device, and A-Series casement window in clear coat pine with modified colonial grilles with 2 1/4" rail to simulate a double-hung window.

WINDOW TYPES

The first choice you'll make? Window types! Find out how various window types function, where they work best, and how they create distinct looks.

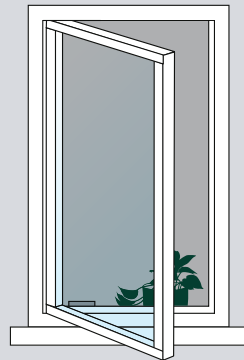

Casement window*

WHAT: The one that cranks open

WHERE: Popular above kitchen sinks because they are easy to open

MINIMUM/MAXIMUM SIZES: 14" W x 72" H**

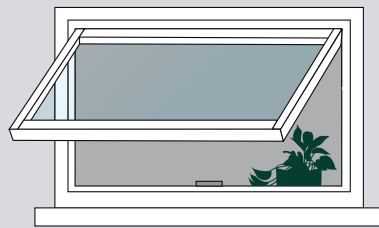

Awning window*

WHAT: The one that cranks open from the bottom

WHERE: Often placed higher on walls for privacy and air flow

MINIMUM/MAXIMUM SIZES: 17 1/2" W x 48" H**

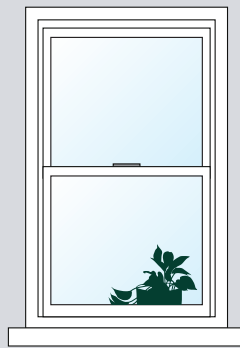

Single- and double-hung windows

WHAT: The ones that slide up and down

WHERE: Often placed...well, everywhere

MINIMUM/MAXIMUM SIZES: 16 1/2" W x 95 1/4" H**

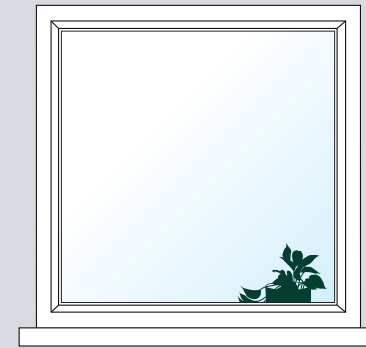

Picture window

WHAT: The one that doesn't open

WHERE: Often combined with windows that do open

MINIMUM/MAXIMUM SIZES: 11 1/2" W x 95 1/2" H**



Gliding window

WHAT: The one that slides side to side

WHERE: Often found in kitchens, bedrooms, and living rooms

MINIMUM/MAXIMUM SIZES: 96" W x 11 1/2" H**



Bow and bay windows

WHAT: The cozy nooks with at least three windows

WHERE: Most often used in living rooms and bedrooms

MINIMUM/MAXIMUM SIZES: 44 1/4" W x 73 3/8" H**

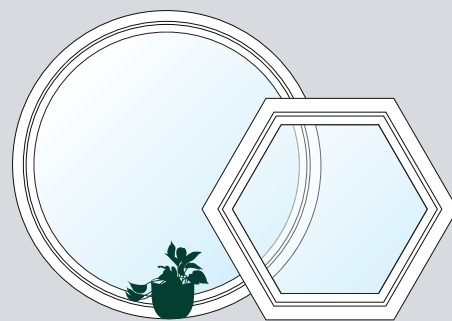

Specialty window

WHAT: The ones that don't open but come in fun shapes

WHERE: Often used as a design statement

MINIMUM/MAXIMUM SIZES: Varies**



Pass-through window

WHAT: Sits just off your countertop and slides smoothly open

WHERE: Popular in kitchens that open to a patio or deck

MINIMUM/MAXIMUM SIZES: 38 5/16" W x 119 1/2" H**

MODERN, TRADITIONAL, OR SOMETHING IN BETWEEN?



Casement, gliding, and picture windows are go-to types for a modern or contemporary home, especially with narrow frames that allow for large expanses of glass.

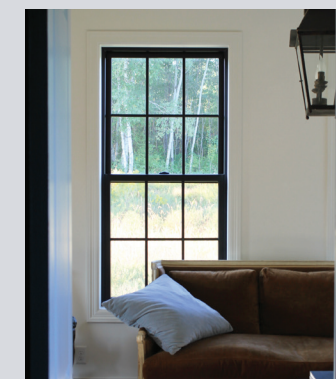

Single- and double-hung windows are simply classic in a traditional home, especially when they feature grilles, and more detailed or decorative frames.



Love a mix of modern and traditional style? We've got selection tips for blending the two no matter the types of windows chosen.

*Drawings reflect approximate operation only. See andersenwindows.com to view specific product details.
**Exact sizes depend on product series chosen. Please see product comparison chart for more details.

CREATING A LOOK

COLOR

Windows are a long-lasting part of your home. To help you pick a color you'll love for as long as they last, we're sharing some tips.

HOW IT WORKS:

- Windows are often one color on the interior to match your woodwork and another color on the outside to match your exterior.
- Depending on the window you choose, you'll pick between a factory finish (painted or stained), or in some cases, you can order your windows unfinished in the interior.
- Most of our windows can be ordered unfinished. This gives you the option of painting or staining them to perfectly match your home's interior woodwork.

Questions to get you thinking about color:

1. Do you want windows that stand out or blend in?
2. What colors suit your home's exterior color?
3. Are there certain colors associated with your home's architectural style?

EXTERIOR COLOR OPTIONS*

Because you might not always dream in (standard) color. With 11 standard colors on most of our products and 50 colors through the E-Series product line, you'll find what you need to bring your style to life.

Shown left to right:
Andersen White
Canvas
Prairie Grass
Sandtone
Terratone
Cocoa Bean
Dark Bronze
Red Rock
Forest Green
Dove Gray
Black

*Exact color options will depend on window product line chosen. Printing limitations prevent exact duplication of colors. See your Andersen supplier for actual color samples.

INTERIOR FINISH OPTIONS*

Choose from a variety of interior wood species as well as factory finished stains and painted interior options to complete the look and style of your windows.

Interior wood species



Pine

Maple

Vertical Grain
Douglas Fir

Oak

Mahogany**

Cherry

Additional interior wood species are available for E-Series products.

Factory-finished interior



Clear Coat

Honey

Cinnamon

Mocha

Russet

Espresso

Shown on pine. Additional factory-finished interior options are available for E-Series products.

Interior painted options

Shown top to bottom:
White
Birch Bark
Primed (for paint)
Canvas
Sandtone
Dark Bronze
Black

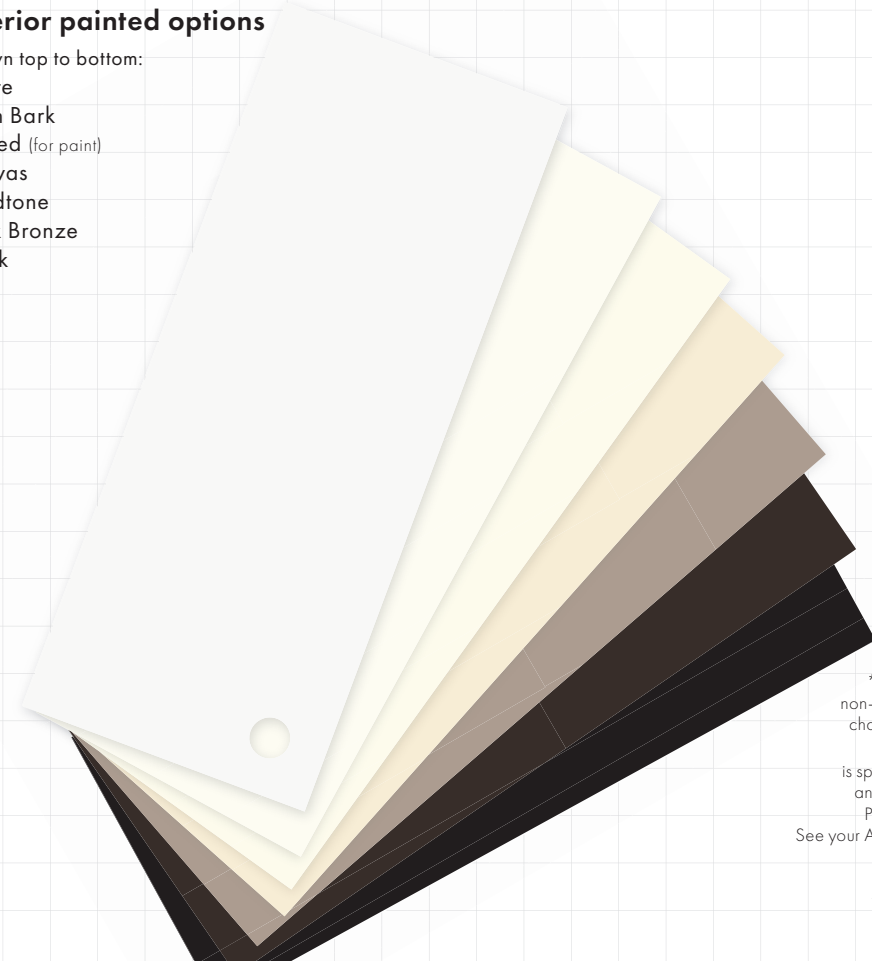

*Exact options will depend on window product line chosen

**Actual wood species is either Sapele or Sipo, both non-endangered species grown in Africa, with color and characteristics similar to Central American mahoganies.

Interiors are unfinished unless a stain or paint option is specified. Naturally occurring variations in grain, color and texture of wood make each window one of a kind.

Printing limitations prevent exact duplication of colors. See your Andersen supplier for actual color and finish samples.

WILL COLOR LAST?

Yes! Our windows are low maintenance and won't need repainting.* The reason for this has to do with materials and construction. Ready for a technical detour?

CLAD WOOD VS. COMPOSITE WINDOWS

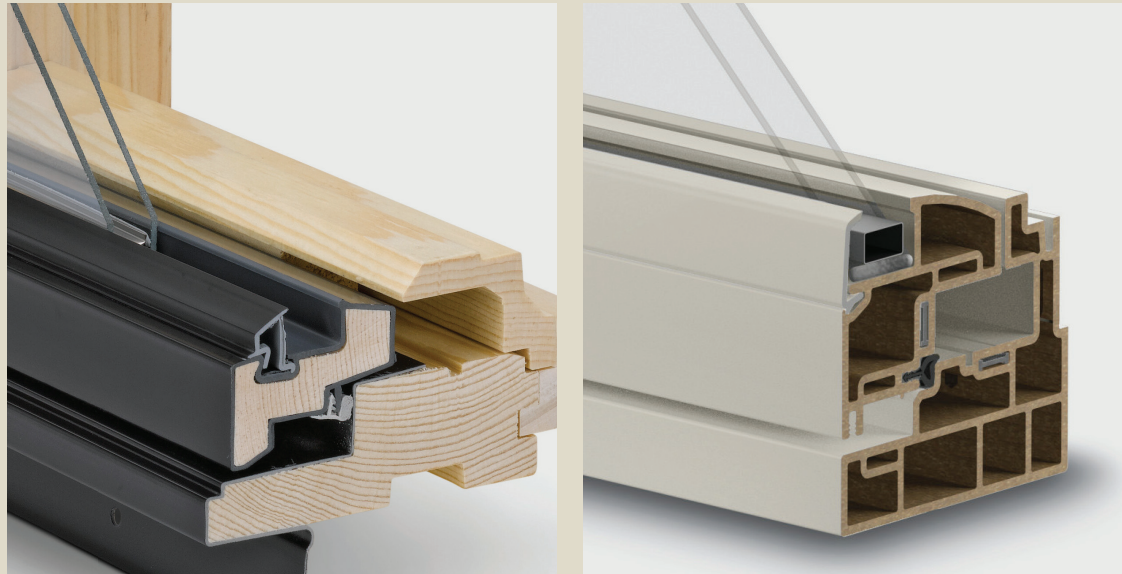

CLAD WOOD

Made of a wood core and covered with a protective material (for example, aluminum on the E-Series), our clad wood windows retain color without requiring repainting due to the durability of their cladding materials.

COMPOSITE

Made of a mix of wood fiber and thermoplastic polymer, Fibrex® material is what our 100 Series composite windows are made of, which is 2X stronger and more durable than vinyl. Color is mixed in during manufacturing. The result is long-lasting beauty that will never fade, flake, blister, or peel.* Plus, 100 Series windows and doors are environmentally responsible and energy efficient, making them a better choice for your home.

*The E-Series, A-Series, and 100 Series product lines come with limited warranties on color finish.

GRILLES

Grilles are typically considered a more traditional feature, but there are also ways to create a contemporary look with them. When selecting grilles, you'll be deciding on pattern and application. To see all the grille options, scan the QR code at the bottom of this page.



COLONIAL

Intended to replicate the old-world charm of individual glass panes, this symmetrical pattern works perfectly on a traditional home like a Cape Cod or a colonial.

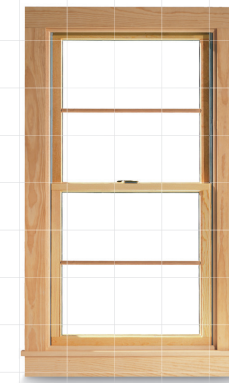

SPECIFIED EQUAL LIGHT

This semi-customizable pattern allows you to choose the number of lights wide and high, so you can create a look that suits a variety of home styles.



SHORT FRACTIONAL

A pattern featuring grilles in the upper sash intended to replicate the look of a transom window.

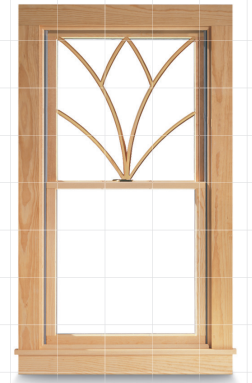

CUSTOM

If you can dream it, chances are we can build it! Let your imagination run free.

5 TYPES OF GRILLES

Grilles can be applied to window glass in various ways. Here's what you should know.

1

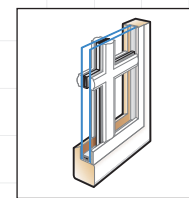

FULL DIVIDED LIGHT

Permanent grilles applied on the interior and exterior with a spacer bar in between the glass provides the most authentic look. An energy-bar upgrade is available for better thermal performance on A-Series windows.

2

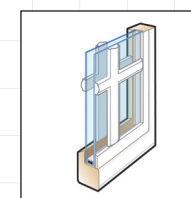

SIMULATED DIVIDED LIGHT

Permanent exterior grilles and permanent (or removable) interior grilles provide a similarly authentic look to full divided light except there's no spacer bar in between the glass.

3

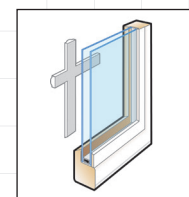

REMOVABLE INTERIOR GRILLES

Removable interior-only grilles add a subtle pattern, while also making windows simple to clean.

4

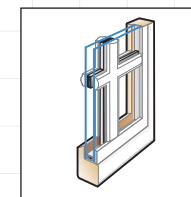

FINELIGHT™ GRILLES-BETWEEN-THE-GLASS

Permanent grilles between the glass only are the best option if you want grilles but also want to be able to easily clean your windows.

5

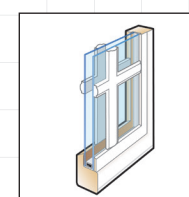

FINELIGHT GRILLES-BETWEEN-THE-GLASS WITH EXTERIOR GRILLES

Permanent grilles on the exterior and in between the glass give a distinctive look to your home's exterior, while making cleaning easy inside.



TRADITIONAL TO MODERN: HARDWARE STYLES AT A GLANCE



EXPLORE
ALL STYLES

TRADITIONAL

TRADITIONAL HARDWARE FEATURES:
Ridges, curves, textured detailing.



ESTATE™
400 Series, shown in antique brass

Curves and ridges



TRADITIONAL BAR LIFT
400 Series, shown in black (matte)



TRADITIONAL FOLDING
400 Series, shown in distressed bronze
(living finish)*

Texture



Ridges

STANDARD LOCK & KEEPER
A-Series, shown in satin nickel

STANDARD LOCK & KEEPER
400 Series, shown in white

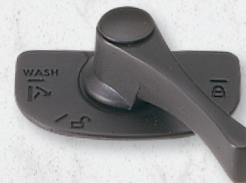

STANDARD LOCK & KEEPER
E-Series, shown in oil rubbed bronze
(living finish)*



HAND LIFT
400 Series, shown in brushed chrome

Sleek lines and
minimal profile



CONTEMPORARY FOLDING
100 Series, shown in white

LOCK HANDLE
400 Series, shown in satin nickel



Minimal profile

CONTEMPORARY BAR LIFT
400 Series, shown in distressed nickel



STANDARD LOCK
200 Series, shown in white

CONTEMPORARY FOLDING
400 Series, shown in satin nickel



Right angles



OPTIONAL METAL SLIM LINE LOCK
100 Series, shown in oil rubbed bronze
(living finish)*

3 tips for selecting hardware:

1 HOW WILL WINDOW COVERINGS WORK?

You want to be able to lower your window treatments without hardware interfering. Folding hardware is a good solution here, especially with casement and awning windows.

2 WHAT OTHER HARDWARE FINISHES ARE ALREADY IN THE ROOM?

Do you want your hardware to match other hardware in the room, like your kitchen cabinet knobs and pulls? Or would you rather it blend in with the window?

3 WHAT FUNCTIONALITIES ARE NEEDED?

For example, A-Series double-hung windows come with tilting mechanisms built into the locking hardware. This makes for easy tilting and allows you to clean your windows from the inside, an especially nice feature on an upper level.

*These finishes are "living" finishes that will change with time and use. Printing limitations prevent exact duplication of colors. See your Andersen supplier for actual finish samples.

GLASS TYPES

No matter the conditions in which you live, we have glass options that will optimize the performance of your windows based on climate, location, and other needs.

Dual-pane vs. triple-pane glass

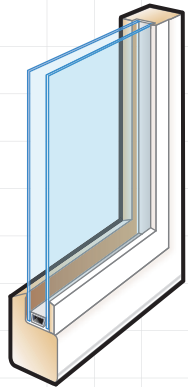

DUAL-PANE GLASS

Dual-pane means there are two panes of uninterrupted glass with an air space in between. Combining this with the right type of climate-specific glass option meets the energy efficiency needs of most people. But when there's a need to take performance to the next level, triple-pane windows are the answer.

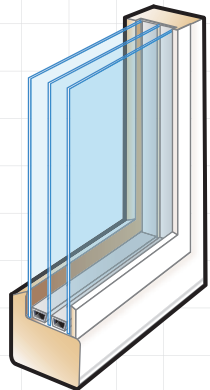

TRIPLE-PANE GLASS

Triple-pane means there's an extra pane of glass and an extra air space, making this our most energy-efficient glass option. In fact, some A-Series triple-pane windows are recognized as ENERGY STAR® most efficient and certified to meet the rigorous level of energy efficiency required by the Passive House Institute U.S. Find triple-pane glass in our 400 Series, A-Series and E-Series product lines.



ENERGY STAR

When you see this logo next to one of our windows, it's an indication of energy efficiency. Energy-efficient windows help lower your heating and cooling costs. Meeting the strict performance requirements of ENERGY STAR certification requires using glass that will reduce the transfer of heat in your climate. Read more about climate-specific glass in the next section.

Climate-specific glass



ALL CLIMATES

Low-emissivity (Low-E) glass is the best option for most people because it reflects heat in the summer and helps keep heat inside in winter. It's available on all Andersen® products.



SOUTHERN CLIMATES

Sun glass offers outstanding thermal performance with a subtle tint that blocks out even more heat from the sun. It's available on 100 Series, 200 Series, 400 Series, A-Series and E-Series windows.

SmartSun™ glass gives the benefits of Low-E, while also helping to reduce 95% of harmful UV rays to help protect your furnishings and decor. It's available on all Andersen® products.



NORTHERN CLIMATES

PassiveSun® glass allows the warmth from the sun to help heat your house. It's available on all Andersen products.

HeatLock® technology is a special coating that can help stop heat from escaping your home. It's available on most glass options.

TALK LIKE A PRO: GLASS 101

There are two things you want to ask about when discussing window glass:

1. What's it coated with? Low-E glass coatings are applied to our window glass to help with energy efficiency by blocking unwanted heat loss or unwanted heat gain—see "Climate-specific glass" above.
2. What's it filled with? The air space in our dual- and triple-pane windows are filled with an argon gas blend that's denser than air and helps improve insulation.

WHAT ELSE CAN GLASS DO FOR MY HOME?

Is your street noisy? How close are your neighbors? Do you live in a coastal area? We have glass upgrades that can meet all these needs.



REDUCE NOISE

For a quieter home, consider windows with a STC (Sound Transmission Class) upgrade, triple-pane glass, or laminated glass.



INCREASE PRIVACY

Increase privacy with options like patterned glass, blinds-between-the-glass* or art glass.**



HURRICANE PROTECTION

Coastal homes can benefit from impact-resistant glass and structural upgrades that meet strict building codes in hurricane-prone areas.†

*Blinds-between-the-glass is available on select E-Series windows.

**Art glass is available on A-Series and E-Series windows.

†See your local code official for code requirements in your area. Coastal window options are available in 100 Series, 400 Series, A-Series, and E-Series.

NEXT PAGE

400 Series casement, picture, and transom windows and a 200 Series Narroline gliding patio door in black



FIND YOUR WINDOW SERIES

100 SERIES \$\$	200 SERIES \$\$	400 SERIES \$\$\$	A-SERIES \$\$\$\$	E-SERIES \$\$\$\$
The Smart Alternative to Vinyl	Warmth of Wood at an Uncommon Value	Time Tested, Classic Wood Craftsmanship	Architectural Authenticity, Unparalleled Performance	Unlimited Possibilities to Create Your Original
Budget-friendly 100 Series windows are made of strong and virtually maintenance-free Fibrex® composite material.	Streamlined 200 Series windows focus on the most popular styles and sizes.	Ever-popular 400 Series windows are the windows contractors trust the most. ¹	Best performing and most energy efficient, A-Series windows are carefully crafted for traditional style.	Customizable E-Series windows are available in unlimited colors and finishes, and dramatic shapes and sizes.
Fibrex® composite material inside and out.	Wood interior/vinyl exterior. ²	Wood interior/composite exterior	Wood interior/aluminum exterior	

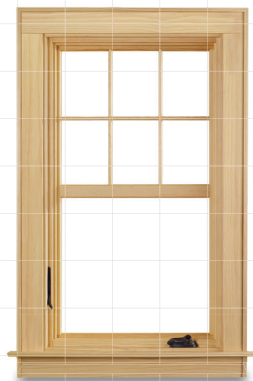
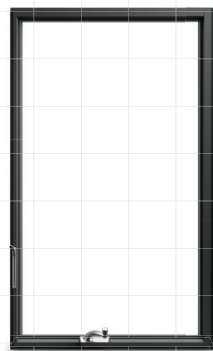

THIS PAGE, LEFT TO RIGHT

100 Series casement window in black, 200 Series tilt-wash double-hung window in white with window opening control device, 400 Series casement window in dark bronze, A-Series casement window in clear coat pine with modified colonial grilles with 2 1/4" rail to simulate a double-hung window, and E-Series double-hung window in mahogany.³



SCAN HERE
FOR PROJECT INSPIRATION

¹2022 Andersen brand survey of U.S. contractors.

²Some products in this series have alternate construction methods and materials used; see individual products for details.

³Actual wood species is either Sapele or Sipo, both non-endangered species grown in Africa, with color and characteristics similar to Central American mahoganies.

Naturally occurring variations in grain, color, and texture of wood make each window one of a kind.

Andersen cannot guarantee consistency in wood grain and/or color within a particular species, product, or project.

MATERIALS MATTER

All of our materials are chosen for their durability, but each possesses unique characteristics. Understanding the difference between materials will help you pick the right windows for your home.

WOOD

Forming the base of our clad windows, it adds beauty to interiors, provides great insulation, and is extremely durable. Wood fiber reclaimed from our manufacturing process is also a key ingredient in our patented Fibrex composite material.

FIBREX® COMPOSITE MATERIAL

Used to make our 100 Series windows inside and out, it's twice as strong as vinyl and made by fusing reclaimed wood fiber and thermoplastic polymer. This innovative material performs well in extreme temperatures and is virtually maintenance free. It's also used as a supporting material in various other product lines.

ALUMINUM

As the protective material (cladding) used on the exterior of E-Series windows, it resists the elements, is virtually maintenance free, and can be customized to various shapes through our extruding process.

FIBERGLASS

Together with Fibrex composite material, this glass-reinforced resin is used on the exterior of our A-Series windows because it's tough, weather resistant, and maintenance free. It's part of what makes A-Series windows so high performing and a great choice in areas with extreme weather, like hurricanes.

VINYL

Used as a protective material (cladding) on 200 and 400 Series windows, this rigid material resists weather and reduces maintenance. Cladding wood in vinyl is a winning innovation that has made the 400 Series our best-selling product line.

WINDOWS COMPARISON CHART	AWNING				BAY/BOW		CASEMENT				SINGLE-HUNG			
	100	400	A	E	400	E	100	400	A	E	100	100	200	
FEATURES														
Exterior Colors														
White	●	●	●	●*	●	●*	●	●	●	●*	●	●	●	
Canvas		●	●	●*	●	●*		●	●	●*				
Prairie Grass			●	●*		●*			●	●*				
Sandtone	●	●	●	●*	●	●*	●	●	●	●*	●	●	●	
Terratone	●	●	●	●*	●	●*	●	●	●	●*	●	●	●	
Cocoa Bean			●	●*		●*			●	●*				
Dark Bronze	●	●	●	●*	●	●*	●	●	●	●*	●	●	●	
Red Rock			●	●*		●*			●	●*				
Forest Green		●	●	●*	●	●*		●	●	●*				
Dove Gray			●	●*		●*			●	●*				
Black	●	●	●	●*	●	●*	●	●	●	●*	●	●	●	
Easy Cleaning														
Tilt-to-Clean Sash												●	●	
Interior Wood Species														
Pine		●	●	●	●	●		●	●	●			●	
Maple			●	●		●			●	●				
Vrt. Grain Douglas Fir			●	●		●			●	●				
Oak			●	●		●			●	●				
Mahogany**			●	●		●			●	●				
Cherry			●	●		●			●	●				
Interior Factory Finishes														
Clear Coat			●	●		●			●	●				
Honey			●	●		●			●	●				
Cinnamon			●	●		●			●	●				
Mocha			●	●		●			●	●				
Russet			●	●		●			●	●				
Espresso			●	●		●			●	●				
Interior Paint Colors														
White	●	●	●	●	●	●	●	●	●	●	●	●	●	
Birch Bark			●	●		●			●	●				
Primed for Paint			●	●		●			●	●				
Canvas		●	●	●		●		●	●	●				
Sandtone	●	●	●	●	●	●	●	●	●	●	●	●	●	
Dark Bronze	●	●	●	●	●	●	●	●	●	●	●	●	●	
Black	●	●	●	●	●	●	●	●	●	●	●	●	●	
Performance Option														
Stormwatch® Protection		●	●	●				●	●	●				
Standard Sizes														
Minimum Height	17 1/2"	17"	15 1/4"	24"	37 7/16"	16"	23 1/2"	24 1/8"	23 1/4"	17 3/4"	23 1/2"	23 1/2"	35 1/2"	
Maximum Height	35 1/2"	40 3/4"	41 1/4"	48"	73 3/8"	72"	71 1/2"	71 1/2"	71 1/4"	72"	89 1/2"	77 1/2"	71 1/2"	
Minimum Width	17 1/2"	24 1/8"	19 1/4"	20"	46 7/8"	44 1/4"	17 1/2"	17"	19 1/4"	14"	17 1/2"	17 1/2"	19 1/2"	
Maximum Width	47 1/2"	71 7/8"	71 1/4"	48"	145 3/8"	120"	35 1/2"	84 5/8"	35 1/4"	40"	47 1/2"	47 1/2"	39 1/2"	
Custom Sizes	●	●	●	●	●	●	●	●	●	●	●	●	●	

*E-Series exteriors come in 50 colors, 7 anodized finishes and custom colors. See andersenwindows.com/e-series for details.
 **Actual wood species is either Sapele or Sipo, both non-endangered species grown in Africa, with color and characteristics similar to Central American mahoganies.

DOUBLE-HUNG				GLIDING				PICTURE				SPECIALTY					
400	Woodwright®	A	E	100	200	400	E	100	200	400	A	E	100	400	A	E	
●	●	●	●*	●	●	●	●*	●	●	●	●*	●	●	●	●*	●	●
●	●	●	●*			●	●*			●	●*			●	●*		●
		●	●*				●*				●*				●*		●*
●	●	●	●*	●	●	●	●*	●	●	●	●*	●	●	●	●*	●	●
●	●	●	●*	●	●	●	●*	●	●	●	●*	●	●	●	●*	●	●
		●	●*				●*				●*				●*		●*
●	●	●	●*			●	●*			●	●*			●	●*		●*
		●	●*				●*				●*				●*		●*
●	●	●	●*			●	●*			●	●*			●	●*		●*
		●	●*				●*				●*				●*		●*
●	●	●	●*	●	●	●	●*	●	●	●	●*	●	●	●	●*	●	●
		●	●*				●*				●*				●*		●*
●	●	●	●*			●	●*			●	●*			●	●*		●*
		●	●*				●*				●*				●*		●*
●	●	●	●*	●	●	●	●*	●	●	●	●*	●	●	●	●*	●	●
		●	●*				●*				●*				●*		●*
●	●	●	●*			●	●*			●	●*			●	●*		●*
		●	●*				●*				●*				●*		●*
●	●	●	●*	●	●	●	●*	●	●	●	●*	●	●	●	●*	●	●
		●	●*				●*				●*				●*		●*
●	●	●	●*			●	●*			●	●*			●	●*		●*
		●	●*				●*				●*				●*		●*
●	●	●	●*	●	●	●	●*	●	●	●	●*	●	●	●	●*	●	●
		●	●*				●*				●*				●*		●*
●	●	●	●*			●	●*			●	●*			●	●*		●*
		●	●*				●*				●*				●*		●*
●	●	●	●*	●	●	●	●*	●	●	●	●*	●	●	●	●*	●	●
		●	●*				●*				●*				●*		●*
●	●	●	●*			●	●*			●	●*			●	●*		●*
		●	●*				●*				●*				●*		●*
●	●	●	●*	●	●	●	●*	●	●	●	●*	●	●	●	●*	●	●
		●	●*				●*				●*				●*		●*
●	●	●	●*			●	●*			●	●*			●	●*		●*
		●	●*				●*				●*				●*		●*
●	●	●	●*	●	●	●	●*	●	●	●	●*	●	●	●	●*	●	●
		●	●*				●*				●*				●*		●*
●	●	●	●*			●	●*			●	●*			●	●*		●*
		●	●*				●*				●*				●*		●*
●	●	●	●*	●	●	●	●*	●	●	●	●*	●	●	●	●*	●	●
		●	●*				●*				●*				●*		●*
●	●	●	●*			●	●*			●	●*			●	●*		●*
		●	●*				●*				●*				●*		●*
●	●	●	●*	●	●	●	●*	●	●	●	●*	●	●	●	●*	●	●
		●	●*				●*				●*				●*		●*
●	●	●	●*			●	●*			●	●*			●	●*		●*
		●	●*				●*				●*				●*		●*
●	●	●	●*	●	●	●	●*	●	●	●	●*	●	●	●	●*	●	●
		●	●*				●*				●*				●*		●*
●	●	●	●*			●	●*			●	●*			●	●*		●*
		●	●*				●*				●*				●*		●*
●	●	●	●*	●	●	●	●*	●	●	●	●*	●	●	●	●*	●	●
		●	●*				●*				●*				●*		●*
●	●	●	●*			●	●*			●	●*			●	●*		●*
		●	●*				●*				●*				●*		●*
●	●	●	●*	●	●	●	●*	●	●	●	●*	●	●	●	●*	●	●
		●	●*				●*				●*				●*		●*
●	●	●	●*			●	●*			●	●*			●	●*		●*
		●	●*				●*				●*				●*		●*
●	●	●	●*	●	●	●	●*	●	●	●	●*	●	●	●	●*	●	●
		●	●*				●*				●*				●*		●*
●	●	●	●*			●	●*			●	●*			●	●*		●*
		●	●*				●*				●*				●*		●*
●	●	●	●*	●	●	●	●*	●	●	●	●*	●	●	●	●*	●	●
		●	●*				●*				●*				●*		●*
●	●	●	●*			●	●*			●	●*			●	●*		●*
		●	●*				●*				●*				●*		●*
●	●	●	●*	●	●	●	●*	●	●	●	●*	●	●	●	●*	●	●
		●	●*				●*				●*				●*		●*
●	●	●	●*			●	●*			●	●*			●	●*		●*
		●	●*				●*				●*				●*		●*
●	●	●	●*	●	●	●	●*	●	●	●	●*	●	●	●	●*	●	●
		●	●*				●*				●*				●*		●*
●	●	●	●*			●	●*			●	●*			●	●*		●*
		●	●*				●*				●*				●*		●*
●	●	●	●*	●	●	●	●*	●	●	●	●*	●	●	●	●*	●	●
		●	●*				●*				●*				●*		●*
●	●	●	●*</														



THE ENVIRONMENT HAS A BUSINESS PARTNER

Respect for the environment is nothing new at Andersen. For more than a century, it has been part of who we are. Our commitment to recycle and reclaim materials began simply because it was good business. Now it's part of our broader commitment to sustainability and responsible stewardship of all of our resources. Andersen is committed to providing you with long-lasting,* energy-efficient windows and patio doors. Visit andersenwindows.com/sustainability for more information.



Andersen is a charter member of the **U.S. Green Building Council** and a strong supporter of its LEED® (Leadership in Energy and Environmental Design) National Green Building Standard rating system.



Select products are Indoor Advantage Gold™ Certified by SCS Global Services for indoor air quality. Andersen was the first window manufacturer to certify products for indoor air quality, beginning in 2008. For products covered, values, and certificate details, visit andersenwindows.com/environmental.



PARTNER

The Home Depot recognizes Andersen as an Eco Actions Partner — a company who is proactively seeking ways to make products and manufacturing processes safer for the environment, for our families, and for the planet.



Andersen makes windows and doors with options that make them ENERGY STAR® certified throughout the U.S.



Select products are Recycled Content Certified by SCS Global Services. For values and certificate details, visit andersenwindows.com/environmental.



TRUST YOUR HOME TO ANDERSEN™

*Visit andersenwindows.com/warranty for details.

“ENERGY STAR” is a registered trademark of the U.S. Environmental Protection Agency.

The Home Depot logo is a registered trademark of Home Depot, Inc.

“Andersen” and all other marks where denoted are trademarks of Andersen Corporation.

©2026 Andersen Corporation. All rights reserved. 5/26

Available at:



D3077726-686E